

580 - FERRETTI YACHTS

Hull number: 15 - year of built: 2024



MAIN FEATURES

BUILDER	FERRETTI YACHTS	MODEL	580
HULL NUMBER	15	TYPE	Motor Yachts
HULL TYPE	Planing	BOAT NAME	no name
YEAR	2024	CONSTRUCTION MATERIAL	Fiberglass - VTR
LOA	18.24 [m] - 59.10 [ft]	BEAM	5 [m] - 16.5 [ft]
DRAFT	1.50 [m] - 4.11 [ft]	ENGINES	2x Volvo Penta D13 - 1000hp
CRUISING SPEED	26 [kn]	MAX SPEED	32 [kn]
N° GUEST CABIN	3	N° CREW CABIN	1
N. TOILETS	3	ON DISPLAY AT/IN	Italy
COUNTRY	Italy	FLAG	Unregistered
ASKING PRICE	0.00 [euro]	VAT STATUS	Not paid

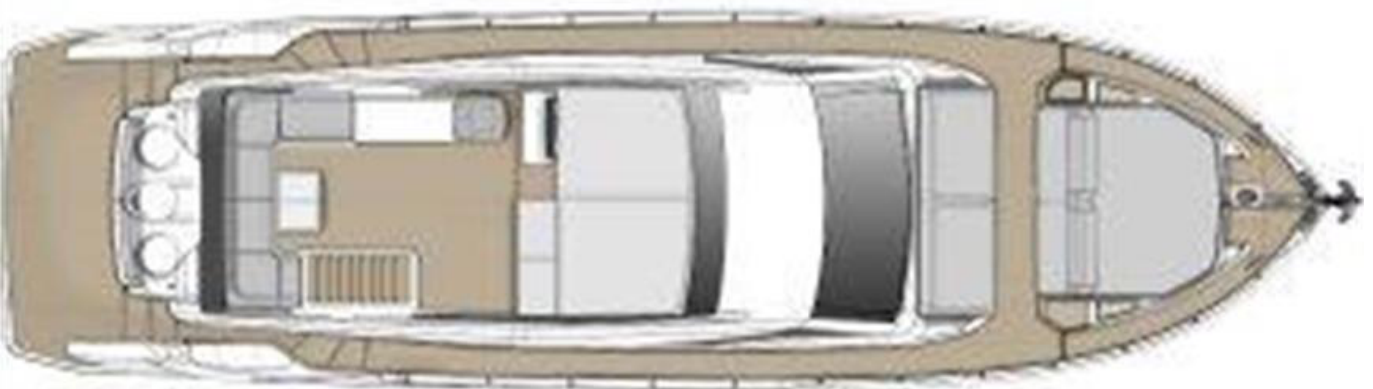

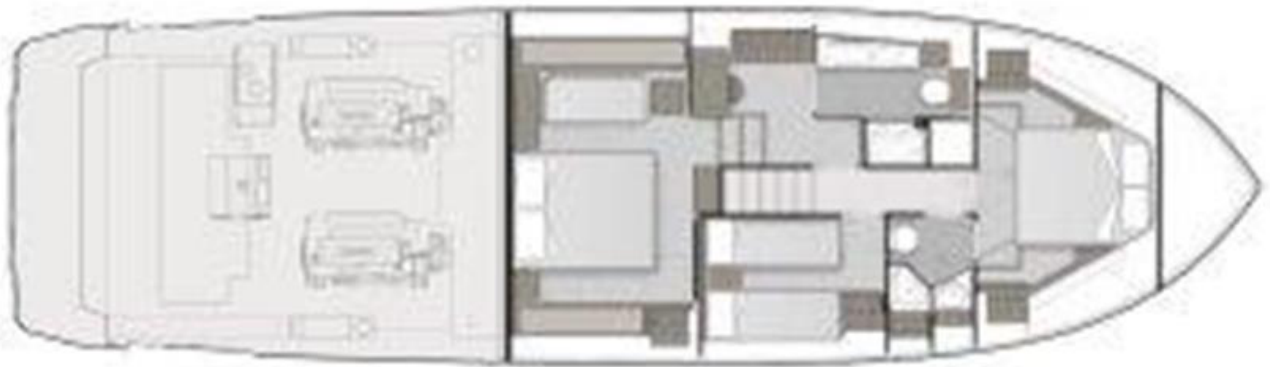
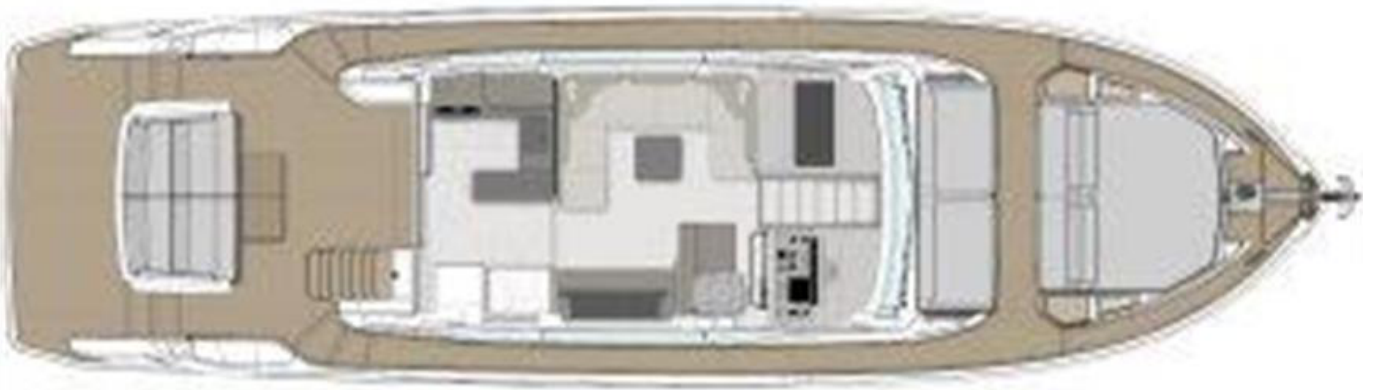

Technical information

Engines hours	0
Trasmissions	V Drive
Fuel tank	3250 lt
Water tank	700 lt

Description per area

General description

The ground breaking new Ferretti Yachts 580 at 18m (59ft) sets a high bar in many parameters, performance from smaller more efficient Volvo engines with the aft V-Drive power configuration gaining a massive amount of extra internal spaces and a faster more quiet ride in any sea state, always a few knots faster than the competition. Open plan vistas and oversized windows, open sightlines and an exceptional quality interior add up to a fitting addition to this world class yacht range. Scheduled to be delivered in May 2024 in Italy, adding a sense of exclusivity and anticipation for potential buyers.

Optional list

Dishwasher for 10 people
Refrigerator on the fly (50 liters)
Icemaker in cockpit
Teppanyaki
Wine cooler
Generator Upgrade
Schuko plugs for all the boat
Shore fresh water intake
Additional plug in cockpit
Anchor upgrade (50 kg and 120 mt chain)
Flybridge co-pilot seat
GRP cover for cockpit mooring stations
Hand rails for swim ladder
Hard Top
Mooring winches - couple
Primer application under the antifouling
Teak on the lifting platform with grey caulking
Teak on Flybridge with grey caulking
Teak table on the fly (foldable)
Teak with grey caulking for cockpit and steps
Cover for exterior cushions and tables
Winch 2300W at bow
Third bathroom dedicated to the VIP cabin
Mediterranean AC
Air extractors in the bathrooms
Crew cabin
Electric blackout and curtains for the master cabin
Electric curtains for the salon
50" Mirror TV in the master cabin
65" TV in salon
AIS transponder SIMRAD NAIS500
Digital chain counter on the fly
Simrad autopilot control system
SIMRAD display upgrade
Stern thruster
Gyro stabilizers
Retractable gangway
Lifting platform
Induction cooking plate in the galley
Wooden floor in the main deck (Cadorin oak)
Additional socket in the galley (over the existing socket to the left)
Master cabin sofa in Aurim top 608 and Rada Pratico 401
Galley top in Fenix Bronzo Doha

Disclaimer

BROKERS offer the details of this vessel in good faith but cannot guarantee or warrant the accuracy of this information nor warrant the condition of the vessel. Pictures of the vessel have been taken from the catalogue. This document does not represent in any case a contractual term.