

Sunseeker Predator 92



“UM7”

The Sunseeker 92 Predator UM7 is a striking motor yacht built in 2008 and meticulously renovated to offer an unparalleled cruising experience. Powered by twin 1,800 HP Caterpillar engines, this powerful vessel reaches a maximum speed of 29 knots, combining speed and performance with the elegance and sophistication. The yacht features four ensuite cabins, an open-plan saloon, expansive sunbathing areas, and well-equipped galley. Having undergone various improvements in recent years, the yacht boasts modern updates throughout, ensuring that the interior and exterior reflect high standards of style and quality.

YEAR	:	2008
LENGTH TOTAL	:	28.15 m
LENGTH HULL	:	22.98 m
BEAM	:	6.34 m
WEIGHT	:	64.800 kg (half load)
FUEL	:	8.500 litres
WATER	:	1.500 litres
ENGINES	:	2 x 1800 hp Caterpillar C-32 Acert
HOURS	:	2380 y 2580
Speed max.	:	29 knots
Speed cruising	:	20 knots
FLAG	:	Spanish
LYING	:	Mallorca
PRICE	:	€1.800.000 + VAT

All particulars are believed to be correct, but not guaranteed.

Sunseeker Predator 92

LAYOUT:

Accommodation for up to 9 guests in 4 cabins each one with its own bathroom. Main cabin mid ships full beam with large bathroom, Vip cabin at bow with double bed and bathroom and 2 guest cabins with 2 single beds in each (one also with a pullmans bed) and bathroom.
Crew accommodation for 3.

NAVIGATION:

Open array radar antenna
GPS antenna
Radio antenna
TV antenna
2 colour displays for navigation
Automatic pilot
Radio VHF con DSC x2
Depth and log
Electronic engine controls
Navigation equipment repeated on fly helm

EQUIPMENT:

Fin stabilizers ABT TRAC for navigation and zero speed – new 2019
Air conditioning throughout
Generator Kohler 27 KW
Hard top with electric opening
Side door with Access to side walks
Electro hydraulic lifting swim platform
Hydraulic pasarelle
Hydraulic bow thrusters
Hydraulic stern thrusters

All particulars are believed to be correct, but not guaranteed.

Sunseeker Predator 92

Cont.

Teak decks

Swim Ladder

Fly bridge with 2nd control station for manoeuvring

Sun top at bow and at stern

Anchor winch with chain and anchor

Mooring winch in cockpit

220v shore power with automatic battery chargers

Tender Williams 385 Turbojet

AUDIO VISUAL:

Bang & Olufsen sound system with 4 independant zones

Flat screen TV in saloon and 4 cabins

DOMESTIC:

Fridge

Freezer

Micro wave oven

Extractor

Dish washer

Double sink

Ice maker

Washing machine

Wine fridge

Grill BBQ

All particulars are believed to be correct, but not guaranteed.

Sunseeker Predator 92

Sports flybridge deck

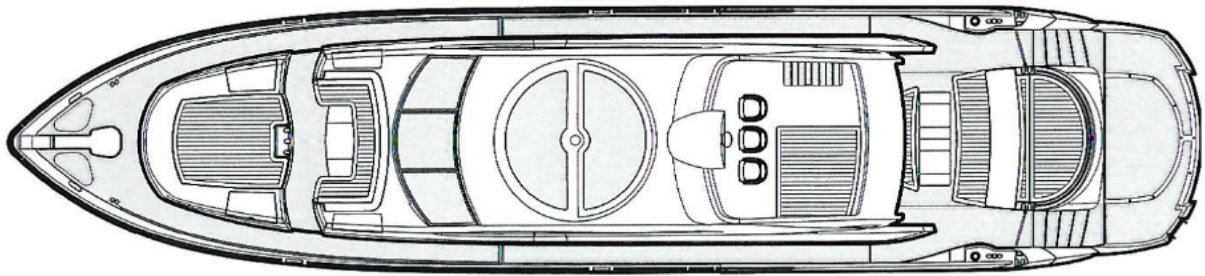

Main deck

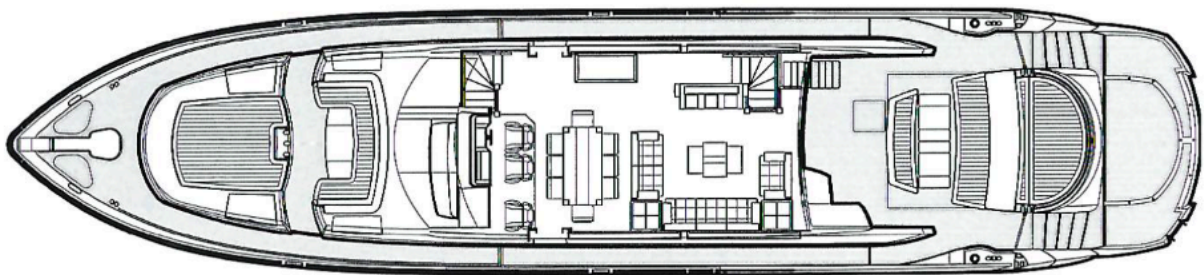

Lower deck

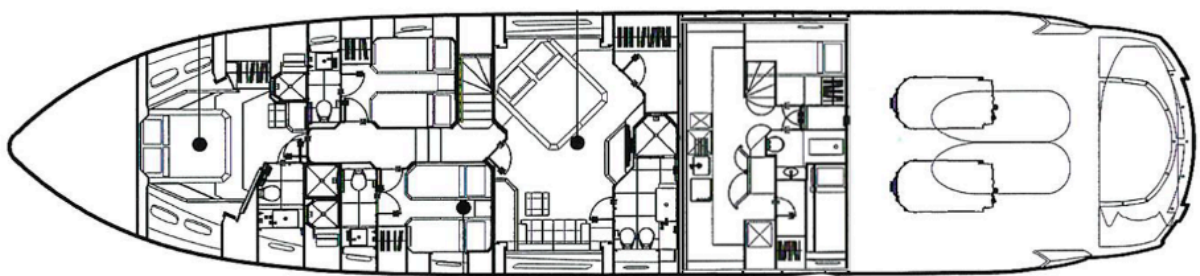

All particulars are believed to be correct, but not guaranteed.