

1999 CLEMNA-ROSSI NAVI 134' – M/Y LADY IN BLUE



MAIN YACHT CHARACTERISTICS:

Boat Name:	LADY IN BLUE	Year:	1999
Builder/Make:	Clemna-Rossi Navi	Model:	134'
Hull Number:	N/A	Type:	Motor Yacht
Length Overall:	134ft 9in 41.07m	Beam:	23ft 8in 7.20m
		Draft:	7ft 9in 2.40m
Engine Make/Model:	2x Wärtsilä Vasa 12V32	Engine horsepower:	2x 1050hp
Propulsion Type:	Shaft Drive	Fuel Type:	Diesel
Cruising Speed:	12 knots	Max Speed:	15 knots
Engine Hours:	270	Range:	1400 nautical miles
Guest Cabins:	5	Crew Cabins:	4
Total Guests:	10	Total Crew:	7
Total Guest Toilets:	6	Crew Toilets:	2
On Display:	Viareggio	Country:	Italy
Flag:	Malta	Private/Commercial:	Commercial
Asking Price:	€ 5,900,000	Tax Status:	VAT Paid

Disclaimer:

Brokers present the particulars of this Vessel in good faith; however, they cannot guarantee or warrant the accuracy of this information, nor do they provide any assurances regarding the Vessel's condition. Images of the Vessel may be sourced from a catalogue. This document shall not, under any circumstances, be deemed a contractual term.

1999 CLEMNA-ROSSI NAVI 134' – M/Y LADY IN BLUE

TECHNICAL CHARACTERISTICS:

RCD / CE Category:	A - Ocean	Classifying Body:	RINA
Main Generator:	Kohler 70kW 50Hz	2nd Generator:	Kohler 70kW 50Hz
Hours:	870	Hours:	870
Fuel Tank:	30000 lt 7925 gal	Water Tank:	8000 lt 2113 gal
Black Tank:	3800 lt 1004 gal	Grey Tank:	3800 lt 1004 gal
Stabiliser(s):	Zero-speed stabilisers	Bow thruster:	Yes
Stern thruster:	Yes	Air conditioning:	Yes - 180,000 BTU

YACHT DESCRIPTION:

Architect:	Alessandro Cusumano	Material:	GRP
Internal Furniture:	Studio Faggioni Yacht Design	External Hull Colour:	Blue and White

LADY IN BLUE is a beautifully refitted 41.10m motor yacht built by Clemna and completed by Rossi Navi, combining classic Italian craftsmanship with modern upgrades. Originally delivered in 1999 and extensively refitted over the years, most recently in 2024, she presents in excellent condition with fully serviced machinery and upgraded exterior areas. Her steel hull and aluminium superstructure ensure robust performance and long-range cruising capability. Designed for comfort and elegance, she offers refined interiors, generous deck spaces and smooth cruising at 12 knots, making her an ideal yacht for extended voyages or commercial use under Maltese registration.

LAYOUT:

The layout of LADY IN BLUE is thoughtfully arranged to provide both privacy and spacious social areas across all decks. She accommodates up to 10 guests in 5 well-appointed cabins, each with en-suite facilities, complemented by an additional day head. The main deck features a large saloon with a formal dining area and a newly refitted galley. The upper deck offers an additional dining space, pantry and bar, ideal for entertaining. Outdoor areas include expansive sunbathing zones on the sundeck and upper deck. Separate crew accommodation for 7 ensures efficient service while maintaining complete guest privacy.

BROKER COMMENTS:

LADY IN BLUE is a 41m displacement yacht by Rossi Navi, built with a durable steel hull and extensively refitted in 2024. Her engines were overhauled to zero hours, new generators installed, and key systems upgraded, effectively renewing her technical lifecycle. This ensures reliability, efficiency and long-range capability, enhanced by newly fitted stabilisers for comfort underway and at anchor. Her contemporary interior by Dada & Associates complements generous exterior spaces. Accommodating 10 guests with 7 crew, she is a turnkey yacht equally suited for private use or charter, offering immediate readiness without the delays of new construction.

Disclaimer:

Brokers present the particulars of this Vessel in good faith; however, they cannot guarantee or warrant the accuracy of this information, nor do they provide any assurances regarding the Vessel's condition. Images of the Vessel may be sourced from a catalogue. This document shall not, under any circumstances, be deemed a contractual term.

1999 CLEMNA-ROSSI NAVI 134' – M/Y LADY IN BLUE

SPECIFICATION:

EQUIPMENT:

General:

Major refits (2007, 2012, 2013, 2024)
Full engine overhaul (recent)
Commercial Maltese registration

External:

Hydraulic gangway
Swimming ladder
Cockpit shower
Mooring winches
Electric windlass
Upper deck dining area (10 guests)
Upper deck bar and sunbeds
Sundeck sunbathing area
Swim platform extension

Internal:

Main saloon dining table (12 guests)
Upper deck pantry
New galley on main deck
Interior refit (guest areas upgraded)

Technical:

2 × Kohler generators (70 kW each)
Air conditioning system (180,000 BTU)
Watermaker Tecnicomar (240 l/h)
Fuel purifier Alfa Laval MAB 103
Shaft drive transmission
5-blade propellers

NAVIGATION:

Autopilot Sperry
Depth sounder Furuno
GPS Furuno
Plotter Vision Master
Gyro compass C. Plath
Speed log Sperry
VHF Sailor
Radar X-band
Radar S-band
2 wing control stations

AUDIO VISUAL:

Smart TV
Speakers (cockpit, foredeck, saloon)

DOMESTIC:

Ice maker
Fridge

TENDER(S) & TOYS:

Williams 550 DieselJet
2 × Seabob
Wakeboard

Disclaimer:

Brokers present the particulars of this Vessel in good faith; however, they cannot guarantee or warrant the accuracy of this information, nor do they provide any assurances regarding the Vessel's condition. Images of the Vessel may be sourced from a catalogue. This document shall not, under any circumstances, be deemed a contractual term.

1999 CLEMNA-ROSSI NAVI 134' – M/Y LADY IN BLUE

SPECIFICATION (continued):

2 × paddle boards
2-seat kayak
Kneeboard

Disclaimer:

Brokers present the particulars of this Vessel in good faith; however, they cannot guarantee or warrant the accuracy of this information, nor do they provide any assurances regarding the Vessel's condition. Images of the Vessel may be sourced from a catalogue. This document shall not, under any circumstances, be deemed a contractual term.

1999 CLEMNA-ROSSI NAVI 134' – M/Y LADY IN BLUE

LAYOUT:

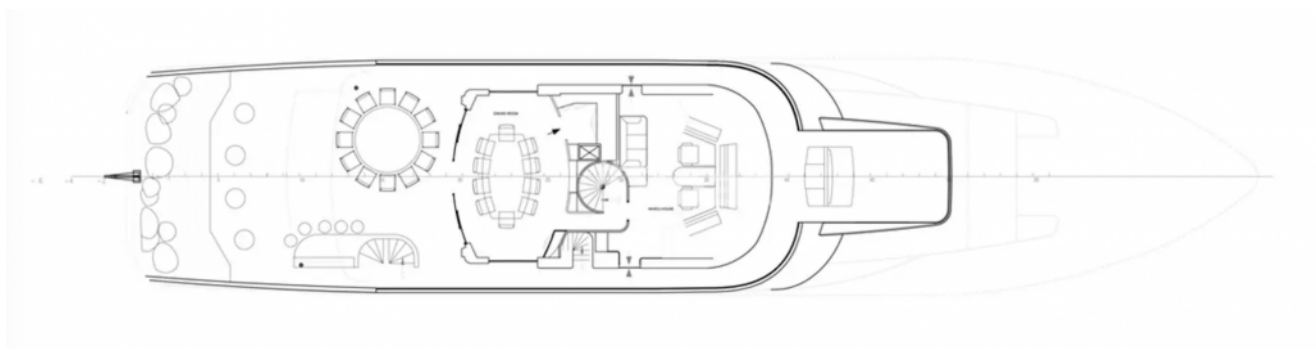
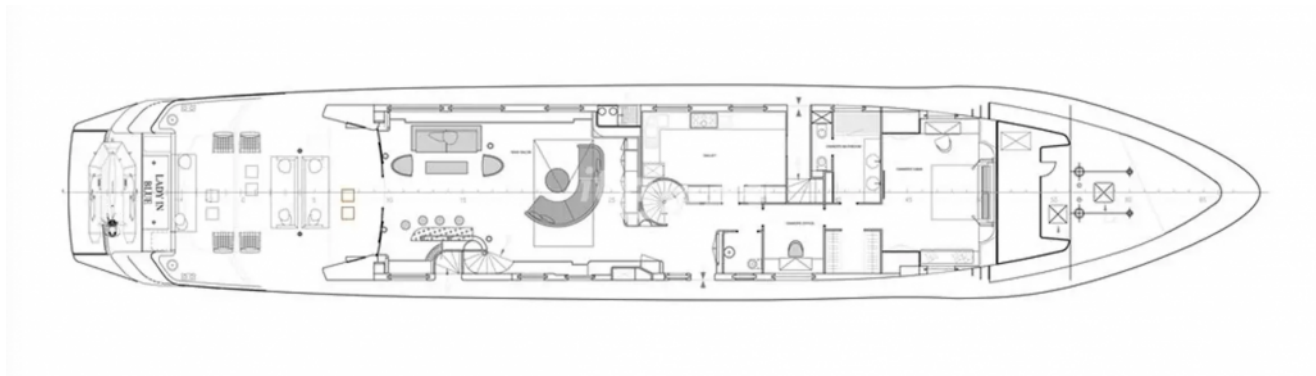

Disclaimer:

Brokers present the particulars of this Vessel in good faith; however, they cannot guarantee or warrant the accuracy of this information, nor do they provide any assurances regarding the Vessel's condition. Images of the Vessel may be sourced from a catalogue. This document shall not, under any circumstances, be deemed a contractual term.