

## 1999 CLEMNA 134' – M/Y LADY IN BLUE



### MAIN YACHT CHARACTERISTICS:

<b>Boat Name:</b>	LADY IN BLUE	<b>Year:</b>	1999
<b>Builder/Make:</b>	Clemna	<b>Model:</b>	134'
<b>Hull Number:</b>	N/A	<b>Type:</b>	Motor Yacht
<b>Length Overall:</b>	134ft 9in 41.07m	<b>Beam:</b>	23ft 8in 7.20m
		<b>Draft:</b>	7ft 9in 2.40m
<b>Engine Make/Model:</b>	2x Wärtsilä Vasa 12V32	<b>Engine horsepower:</b>	2x 1050hp
<b>Propulsion Type:</b>	Shaft Drive	<b>Fuel Type:</b>	Diesel
<b>Cruising Speed:</b>	12 knots	<b>Max Speed:</b>	15 knots
<b>Engine Hours:</b>	270	<b>Range:</b>	1400 nautical miles
<b>Guest Cabins:</b>	5	<b>Crew Cabins:</b>	4
<b>Total Guests:</b>	10	<b>Total Crew:</b>	7
<b>Total Guest Toilets:</b>	6	<b>Crew Toilets:</b>	4
<b>On Display:</b>	Livorno	<b>Country:</b>	Italy
<b>Flag:</b>	Malta	<b>Private/Commercial:</b>	Commercial
<b>Asking Price:</b>	€ 5,900,000	<b>Tax Status:</b>	VAT Paid

#### Disclaimer:

Brokers present the particulars of this Vessel in good faith; however, they cannot guarantee or warrant the accuracy of this information, nor do they provide any assurances regarding the Vessel's condition. Images of the Vessel may be sourced from a catalogue. This document shall not, under any circumstances, be deemed a contractual term.

## 1999 CLEMNA 134' – M/Y LADY IN BLUE

### TECHNICAL CHARACTERISTICS:

<b>RCD / CE Category:</b>	A - Ocean	<b>Classifying Body:</b>	RINA
<b>Main Generator:</b>	Kohler 70kW 50Hz	<b>2nd Generator:</b>	Kohler 70kW 50Hz
<b>Hours:</b>	870	<b>Hours:</b>	870
<b>Fuel Tank:</b>	30000 lt 7925 gal	<b>Water Tank:</b>	8000 lt 2113 gal
<b>Black Tank:</b>	3800 lt 1004 gal	<b>Grey Tank:</b>	3800 lt 1004 gal
<b>Stabiliser(s):</b>	Zero-speed stabilisers	<b>Bow thruster:</b>	Yes
<b>Stern thruster:</b>	Yes	<b>Air conditioning:</b>	Yes - 180,000 BTU

### YACHT DESCRIPTION:

<b>Architect:</b>	Alessandro Cusumano	<b>Material:</b>	STEEL
<b>Internal Furniture:</b>	Studio Faggioni Yacht Design	<b>External Hull Colour:</b>	Blue and White

LADY IN BLUE is a beautifully refitted 41.10m motor yacht built by Clemna, combining classic Italian craftsmanship with modern upgrades. Originally delivered in 1999 and extensively refitted over the years, most recently in 2024, she presents in excellent condition with fully serviced machinery and upgraded exterior areas. Her steel hull and aluminium superstructure ensure robust performance and long-range cruising capability. Designed for comfort and elegance, she offers refined interiors, generous deck spaces and smooth cruising at 12 knots, making her an ideal yacht for extended voyages or commercial use under Maltese registration.

### LAYOUT:

The layout of LADY IN BLUE is thoughtfully arranged to provide both privacy and spacious social areas across all decks. She accommodates up to 10 guests in 5 well-appointed cabins, each with en-suite facilities, complemented by an additional day head. The main deck features a large saloon with a formal dining area and a newly refitted galley. The upper deck offers an additional dining space, pantry and bar, ideal for entertaining. Outdoor areas include expansive sunbathing zones on the sundeck and upper deck. Separate crew accommodation for 7 ensures efficient service while maintaining complete guest privacy.

### BROKER COMMENTS:

LADY IN BLUE is a 41m displacement yacht by Clemna, built with a durable steel hull and extensively refitted in 2024. Her engines were overhauled to zero hours, new generators installed, and key systems upgraded, effectively renewing her technical lifecycle. This ensures reliability, efficiency and long-range capability, enhanced by newly fitted stabilisers for comfort underway and at anchor. Her contemporary interior by Dada & Associates complements generous exterior spaces. Accommodating 10 guests with 7 crew, she is a turnkey yacht equally suited for private use or charter, offering immediate readiness without the delays of new construction.

#### Disclaimer:

Brokers present the particulars of this Vessel in good faith; however, they cannot guarantee or warrant the accuracy of this information, nor do they provide any assurances regarding the Vessel's condition. Images of the Vessel may be sourced from a catalogue. This document shall not, under any circumstances, be deemed a contractual term.

# 1999 CLEMNA 134' – M/Y LADY IN BLUE

## SPECIFICATION:

### EQUIPMENT:

#### General:

Major refits (2007, 2012, 2013, 2024)  
Full engine overhaul (recent)  
Commercial Maltese registration

#### External:

Hydraulic gangway  
Swimming ladder  
Cockpit shower  
Mooring winches  
Electric windlass  
Upper deck dining area (10 guests)  
Upper deck bar and sunbeds  
Sundeck sunbathing area  
Swim platform extension

#### Internal:

Main saloon dining table (12 guests)  
Upper deck pantry  
New galley on main deck  
Interior refit (guest areas upgraded)

#### Technical:

2 × Kohler generators (70 kW each)  
Air conditioning system (180,000 BTU)  
Watermaker Tecnicomar (240 l/h)  
Fuel purifier Alfa Laval MAB 103  
Shaft drive transmission  
5-blade propellers

### NAVIGATION:

Autopilot Sperry  
Depth sounder Furuno  
GPS Furuno  
Plotter Vision Master  
Gyro compass C. Plath  
Speed log Sperry  
VHF Sailor  
Radar X-band  
Radar S-band  
2 wing control stations

### AUDIO VISUAL:

Smart TV  
Speakers (cockpit, foredeck, saloon)

### DOMESTIC:

Ice maker  
Fridge

### TENDER(S) & TOYS:

Williams 550 DieselJet  
2 × Seabob  
Wakeboard

#### Disclaimer:

Brokers present the particulars of this Vessel in good faith; however, they cannot guarantee or warrant the accuracy of this information, nor do they provide any assurances regarding the Vessel's condition. Images of the Vessel may be sourced from a catalogue. This document shall not, under any circumstances, be deemed a contractual term.

## 1999 CLEMNA 134' – M/Y LADY IN BLUE

### SPECIFICATION (continued):

2 × paddle boards

2-seat kayak

Kneeboard

#### **Disclaimer:**

Brokers present the particulars of this Vessel in good faith; however, they cannot guarantee or warrant the accuracy of this information, nor do they provide any assurances regarding the Vessel's condition. Images of the Vessel may be sourced from a catalogue. This document shall not, under any circumstances, be deemed a contractual term.

# 1999 CLEMNA 134' – M/Y LADY IN BLUE

## LAYOUT:

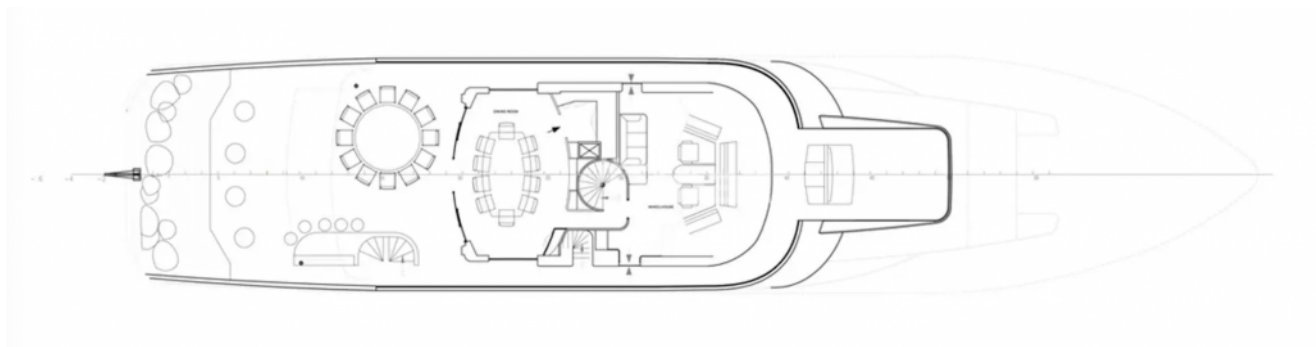
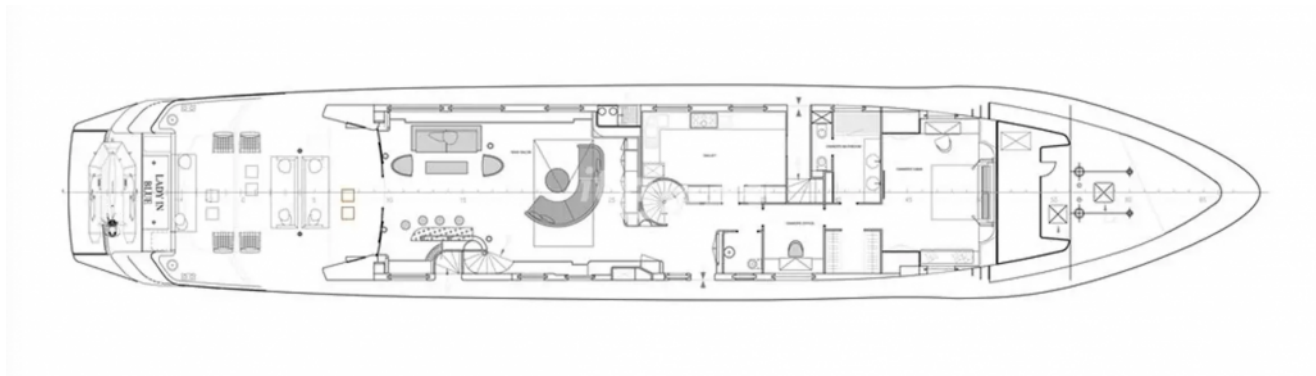

### Disclaimer:

Brokers present the particulars of this Vessel in good faith; however, they cannot guarantee or warrant the accuracy of this information, nor do they provide any assurances regarding the Vessel's condition. Images of the Vessel may be sourced from a catalogue. This document shall not, under any circumstances, be deemed a contractual term.