

## 2007 RIVA 63' VERTIGO – M/Y NESMARI



### MAIN YACHT CHARACTERISTICS:

<b>Boat Name:</b>	NESMARI	<b>Year:</b>	2007
<b>Builder/Make:</b>	Riva	<b>Model:</b>	63' Vertigo
<b>Hull Number:</b>	26	<b>Type:</b>	Motor Yacht
<b>Length Overall:</b>	64ft 2in 19.57m	<b>Beam:</b>	15ft 9in 4.80m
		<b>Draft:</b>	5ft 3in 1.60m
<b>Engine Make/Model:</b>	2x MAN V12-1360	<b>Engine horsepower:</b>	2x 1360hp
<b>Propulsion Type:</b>	V Drive	<b>Fuel Type:</b>	Diesel
<b>Cruising Speed:</b>	34 knots	<b>Max Speed:</b>	40 knots
<b>Engine Hours:</b>	1728	<b>Range:</b>	270 nautical miles
<b>Guest Cabins:</b>	3	<b>Crew Cabins:</b>	1
<b>Total Guests:</b>	6	<b>Total Crew:</b>	1
<b>Total Guest Toilets:</b>	3	<b>Crew Toilets:</b>	1
<b>On Display:</b>	Marbella	<b>Country:</b>	Spain
<b>Flag:</b>	Spanish	<b>Private/Commercial:</b>	Private
<b>Asking Price:</b>	€ 925,000	<b>Tax Status:</b>	VAT Paid

#### Disclaimer:

Brokers present the particulars of this Vessel in good faith; however, they cannot guarantee or warrant the accuracy of this information, nor do they provide any assurances regarding the Vessel's condition. Images of the Vessel may be sourced from a catalogue. This document shall not, under any circumstances, be deemed a contractual term.

## 2007 RIVA 63' VERTIGO – M/Y NESMARI

### TECHNICAL CHARACTERISTICS:

<b>RCD / CE Category:</b>	A - Ocean	<b>Classifying Body:</b>	RINA
<b>Main Generator:</b>	Kohler 13kW 50Hz	<b>2nd Generator:</b>	/
<b>Hours:</b>	3300	<b>Hours:</b>	/
<b>Fuel Tank:</b>	3200 lt 845 gal	<b>Water Tank:</b>	660 lt 174 gal
<b>Black Tank:</b>	330 lt 87 gal	<b>Grey Tank:</b>	330 lt 87 gal
<b>Stabiliser(s):</b>	Trim tabs system	<b>Bow thruster:</b>	Yes
<b>Stern thruster:</b>	Yes (Sidepower)	<b>Air conditioning:</b>	Yes

### YACHT DESCRIPTION:

<b>Architect:</b>	Officina Italiana Design	<b>Material:</b>	GRP
<b>Internal Furniture:</b>	High-gloss cherry wood	<b>External Hull Colour:</b>	Metallic Silver

M/Y NESMARI is a Riva 63' Vertigo that captures the essence of the model - sleek, fast and unmistakably elegant. Finished in a custom metallic silver hull, she presents a more contemporary look while retaining the timeless Riva character. Powered by twin MAN engines, she delivers strong performance with a comfortable cruising profile. Maintained with care by a full-time crew, she benefits from updated navigation electronics in 2022 and a specification that supports easy, enjoyable use. The hard top with extended aft section enhances onboard living, making her a versatile and well-rounded yacht for Mediterranean cruising.

### LAYOUT:

The layout is practical and well balanced, offering comfortable accommodation for six guests across three cabins. The full-beam master sits amidships, with a forward VIP cabin and a twin guest cabin, all with en-suite bathrooms. The main deck is centred around a bright saloon connected to the cockpit, creating a natural flow between interior and exterior spaces. The hard top provides shade and protection while maintaining an open feel. Circulation is simple and intuitive, with easy access to the bow sunbathing area and aft deck. A separate crew cabin ensures privacy and smooth day-to-day operation onboard.

### BROKER COMMENTS:

M/Y NESMARI is a well-kept Vertigo with a strong spec and modern updates, offering a clean, straightforward opportunity in a segment where condition and usability make all the difference.

#### Disclaimer:

Brokers present the particulars of this Vessel in good faith; however, they cannot guarantee or warrant the accuracy of this information, nor do they provide any assurances regarding the Vessel's condition. Images of the Vessel may be sourced from a catalogue. This document shall not, under any circumstances, be deemed a contractual term.

# 2007 RIVA 63' VERTIGO – M/Y NESMARI

## SPECIFICATION:

### EQUIPMENT:

#### General:

Custom metallic silver hull finish  
Full-time crew maintained

#### External:

Hard top with extended aft fibreglass section  
Teak decking (cockpit, side decks, swim platform)  
Hydraulic bathing platform  
Hydraulic passerelle  
Swim ladder  
Cockpit wet bar with sink and ice maker

#### Internal:

Layout: 3 guest cabins with en-suite bathrooms  
Crew cabin  
Saloon with seating and dining area

#### Technical:

2 × MAN 1360hp engines  
Kohler generator  
Air conditioning  
Bow thruster  
Stern thruster (Side Power, new 2022)  
Trim tabs system (flaps)  
Black water tank system  
Fresh water WC system  
Shore power with battery charger

#### NAVIGATION:

Raymarine HybridTouch displays (new 2022)  
Raymarine autopilot p70Rs (new 2022)  
Raymarine radar and GPS (new 2022)  
Raymarine VHF with DSC (new 2022)  
Loudhailer Standard Horizon (new 2022)  
Tridata (speed, depth, wind)

#### AUDIO VISUAL:

40" TV in saloon  
22" TV in master cabin  
Bose sound system (3 zones: interior, bow, stern)  
Hi-fi system in cabins

#### DOMESTIC:

Fridge / freezer  
Ceramic cooker  
Microwave oven  
Dishwasher  
Extractor hood

#### TENDER(S) & TOYS:

Williams 325 Turbojet  
Garage with hydraulic opening and winch

#### Disclaimer:

Brokers present the particulars of this Vessel in good faith; however, they cannot guarantee or warrant the accuracy of this information, nor do they provide any assurances regarding the Vessel's condition. Images of the Vessel may be sourced from a catalogue. This document shall not, under any circumstances, be deemed a contractual term.

2007 RIVA 63' VERTIGO – M/Y NESMARI

LAYOUT:

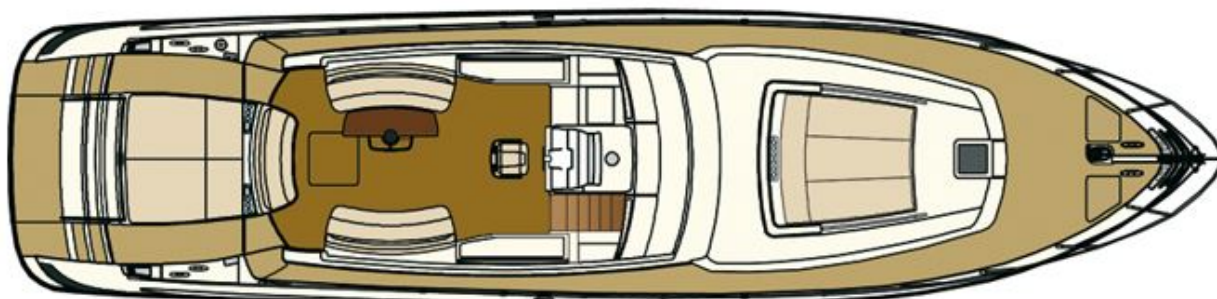
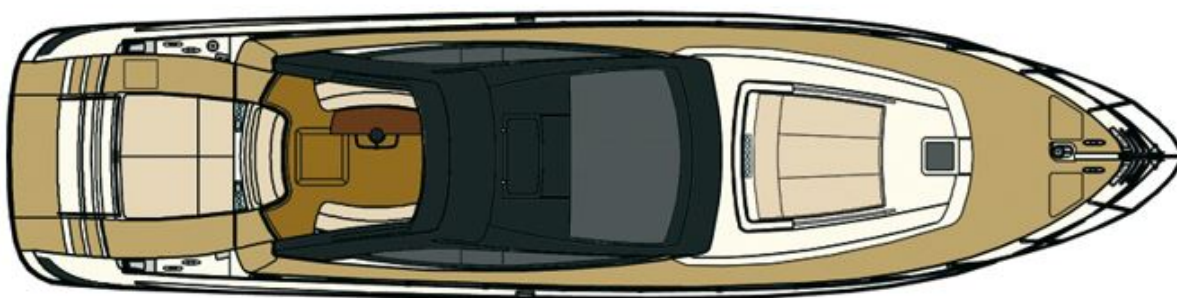

**Disclaimer:**

Brokers present the particulars of this Vessel in good faith; however, they cannot guarantee or warrant the accuracy of this information, nor do they provide any assurances regarding the Vessel's condition. Images of the Vessel may be sourced from a catalogue. This document shall not, under any circumstances, be deemed a contractual term.

**2007 RIVA 63' VERTIGO – M/Y NESMARI**

**LAYOUT (continued):**

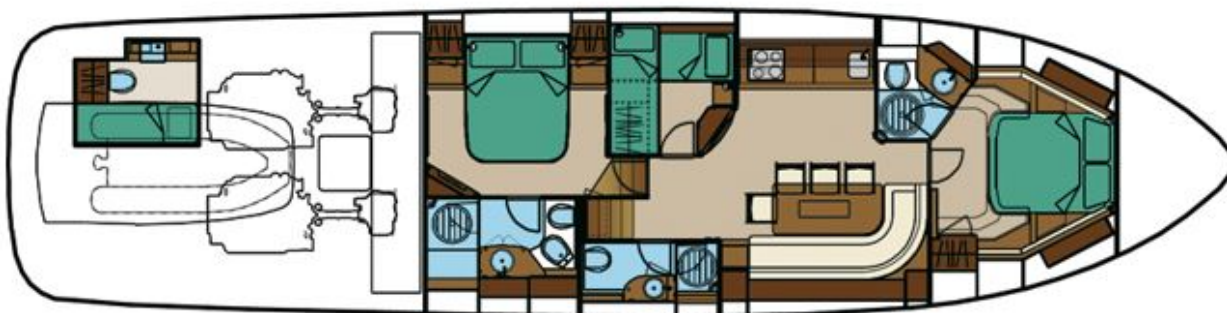

**Disclaimer:**

Brokers present the particulars of this Vessel in good faith; however, they cannot guarantee or warrant the accuracy of this information, nor do they provide any assurances regarding the Vessel's condition. Images of the Vessel may be sourced from a catalogue. This document shall not, under any circumstances, be deemed a contractual term.