

2013 RIVA 52' RIVALE – M/Y S KRIS



MAIN YACHT CHARACTERISTICS:

Boat Name:	S KRIS	Year:	2013
Builder/Make:	Riva	Model:	52' Rivale
Hull Number:	84	Type:	Motor Yacht
Length Overall:	52ft 9in 16.12m	Beam:	14ft 10in 4.57m
		Draft:	4ft 6in 1.40m
Engine Make/Model:	2x MAN V8-900	Engine horsepower:	2x 900hp
Propulsion Type:	V Drive	Fuel Type:	Diesel
Cruising Speed:	32 knots	Max Speed:	37 knots
Engine Hours:	595	Range:	230 nautical miles
Guest Cabins:	3	Crew Cabins:	0
Total Guests:	6	Total Crew:	0
Total Guest Toilets:	2	Crew Toilets:	0
On Display:	Malaga	Country:	Spain
Flag:	British	Private/Commercial:	Private
Asking Price:	€ 700,000	Tax Status:	VAT Paid

Disclaimer:

Brokers present the particulars of this Vessel in good faith; however, they cannot guarantee or warrant the accuracy of this information, nor do they provide any assurances regarding the Vessel's condition. Images of the Vessel may be sourced from a catalogue. This document shall not, under any circumstances, be deemed a contractual term.

2013 RIVA 52' RIVALE – M/Y S KRIS

TECHNICAL CHARACTERISTICS:

RCD / CE Category:	A - Ocean	Classifying Body:	RINA
Main Generator:	Kohler 13kW 50Hz	2nd Generator:	/
Hours:	960	Hours:	/
Fuel Tank:	2500 lt 660 gal	Water Tank:	500 lt 132 gal
Black Tank:	330 lt 87 gal	Grey Tank:	330 lt 87 gal
Bow thruster:	Side-Power electric	Stern thruster:	Side-Power electric
Air conditioning:	Condaria		

YACHT DESCRIPTION:

Architect:	Officina Italiana Design	Material:	GRP
Internal Furniture:	Light Oak Wood	External Hull Colour:	Metallic Sand Grey

M/Y S KRIS is a beautifully presented 2013 Riva 52 Rivale, a model celebrated for combining timeless Italian styling with exhilarating performance. Powered by twin 900 hp MAN engines, she delivers impressive speed while retaining the refined handling and build quality synonymous with the Riva name. Finished in elegant Metallic Grey Sand, she benefits from numerous upgrades including new Raymarine electronics installed in 2023, an extended hydraulic bathing platform and refreshed exterior features. Her generous cockpit, practical tender garage and beautifully appointed interior create a yacht equally suited to relaxed Mediterranean cruising or entertaining family and friends in complete comfort.

LAYOUT:

The accommodation has been thoughtfully arranged to maximise both comfort and privacy. Below deck, the owner's cabin is complemented by a forward VIP cabin and a twin guest cabin, served by two well-appointed bathrooms. The saloon provides a welcoming lounge with an integrated dining area, seamlessly connected to the practical galley for easy onboard living. Outside, the spacious cockpit centres around a wet bar, creating an inviting environment for entertaining, while generous sunbathing areas forward and aft offer ample space to relax. A dedicated garage accommodates a 3.2-metre Avon Jet tender, keeping deck spaces clean and uncluttered throughout.

BROKER COMMENTS:

Some yachts simply age better than others. S KRIS is one of them—a carefully updated Rivale that captures everything owners love about the model, ready to enjoy from the very first day.

Disclaimer:

Brokers present the particulars of this Vessel in good faith; however, they cannot guarantee or warrant the accuracy of this information, nor do they provide any assurances regarding the Vessel's condition. Images of the Vessel may be sourced from a catalogue. This document shall not, under any circumstances, be deemed a contractual term.

2013 RIVA 52' RIVALE – M/Y S KRIS

SPECIFICATION:

EQUIPMENT:

General:

Metallic Grey Sand hull and superstructure
Professionally maintained

External:

Extended hydraulic bathing platform
Teak decking to cockpit
Teak side decks
Teak foredeck
Besenzoni hydraulic passerelle
Electric raising bimini (new canvas 2023)
Foldable mahogany cockpit table
Exterior cockpit wet bar
Twin cockpit refrigerators
Cockpit sink
Bow sunbathing area
Aft sunbathing area
Exterior cushions
Stainless steel handrails
Courtesy lighting to cockpit and bathing platform
Courtesy lighting in tender garage
Tender garage with electric winch
Liferaft

Internal:

Three guest cabins
Two bathrooms
Integrated saloon dining area
Integrated galley
Condaria air conditioning
Tecma electric toilets

Technical:

Twin MAN V10 CRM 1100 hp engines
Kohler 13 kW generator
Side-Power electric bow thruster
Side-Power electric stern thruster
Electronic engine controls
Shore power connection
Automatic battery charger
Electric Lofrans anchor windlass
Electric Lofrans stern mooring winch

NAVIGATION:

Refit 2023: New Raymarine HybridTouch multifunction display
Refit 2023: Raymarine radar
GPS chartplotter
Refit 2023: Raymarine depth sounder
Autopilot
Refit 2023: Raymarine rudder angle indicator
Refit 2023: B&G VHF radio
Compass
MAN engine displays
Fuel and tank monitoring display

Disclaimer:

Brokers present the particulars of this Vessel in good faith; however, they cannot guarantee or warrant the accuracy of this information, nor do they provide any assurances regarding the Vessel's condition. Images of the Vessel may be sourced from a catalogue. This document shall not, under any circumstances, be deemed a contractual term.

2013 RIVA 52' RIVALE – M/Y S KRIS

SPECIFICATION (continued):

Aft camera
Engine room thermal camera

AUDIO VISUAL:

Saloon TV
BOSE sound system in saloon
Master cabin TV
Fusion sound system in master cabin
Exterior stereo system
Four cockpit loudspeakers

DOMESTIC:

Refrigerator/freezer
Ceramic hob
Dishwasher
Microwave
Galley sink
Cockpit wet bar
Two cockpit refrigerators
Cockpit sink

TENDER(S) & TOYS:

Avon Jet tender
Tender garage with electric winch

Disclaimer:

Brokers present the particulars of this Vessel in good faith; however, they cannot guarantee or warrant the accuracy of this information, nor do they provide any assurances regarding the Vessel's condition. Images of the Vessel may be sourced from a catalogue. This document shall not, under any circumstances, be deemed a contractual term.

2013 RIVA 52' RIVALE – M/Y S KRIS

LAYOUT:

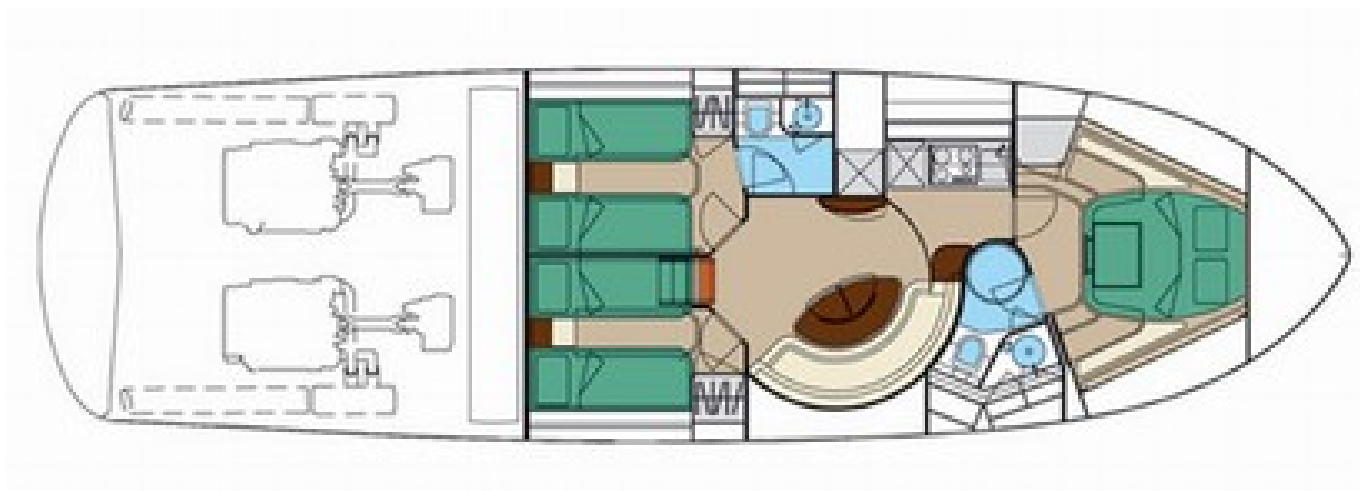
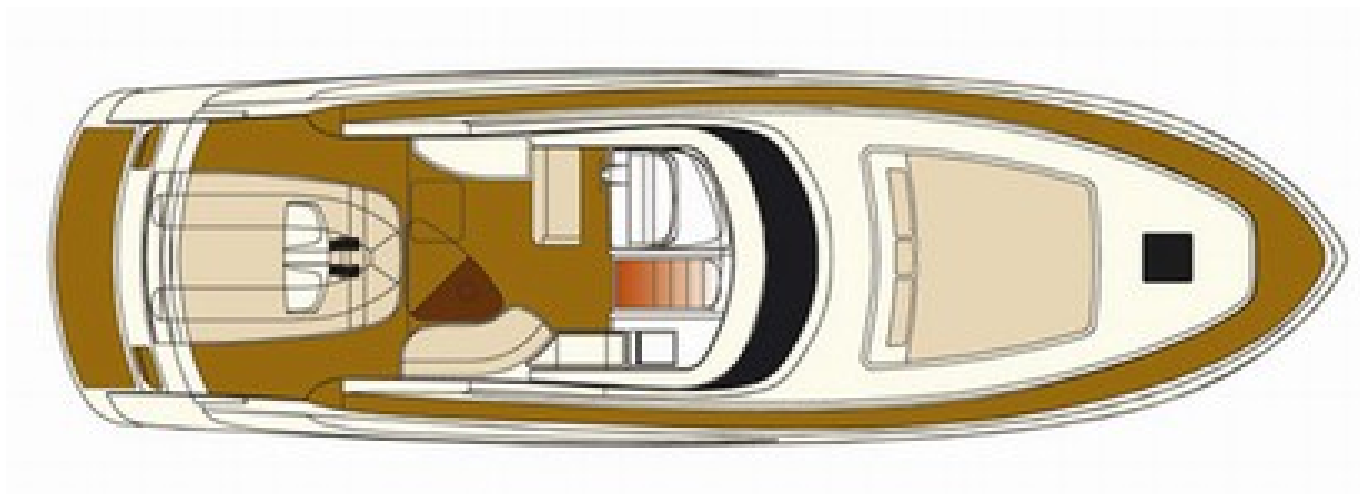

Disclaimer:

Brokers present the particulars of this Vessel in good faith; however, they cannot guarantee or warrant the accuracy of this information, nor do they provide any assurances regarding the Vessel's condition. Images of the Vessel may be sourced from a catalogue. This document shall not, under any circumstances, be deemed a contractual term.